

150LB FITTINGS

BSP FULL SOCKET



Size 1/8" - 6"

BSP HALF SOCKET



Size 1/8" - 6"

BSP RED SOCKET



Size 1/4" x 1/8" - 4" x 3"

BSP 90 ELBOW



Size 1/8" - 4"

BSP 45 ELBOW



Size 1/8" - 4"

MALE/FEMALE 90 ELBOW



Size 1/8" - 4"

BSP EQUAL TEE



Size 1/8" - 4"

BSP EQUAL CROSS



Size 1/8" - 3"

BSP HEXAGON UNION



Size 1/8" - 4"

MALE/FEMALE UNION



Size 1/8" - 2"

BSP BARREL NIPPLE



Size 1/8" - 6"

*Non-standard lengths available

BSP WELDING NIPPLE



Size 1/8" - 6"

*Non-standard lengths available

150LB FITTINGS

BSP HEX NIPPLES



Size 1/8" - 4"

BSP HEX RED NIPPLE



Size 1/4"x 1/8" - 4" x 3"

BSP RUNNING NIPPLE



Size 1/8" - 4"

*Non-standard lengths available

BSP HOSE TAIL

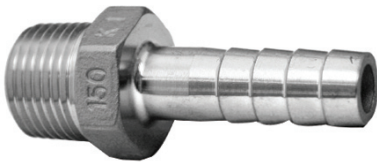

Size 1/8" - 4"

BSP END CAP



Size 1/8" - 4"

* Hexagon type also available

BSP MALE BENDS



Size 1/8" - 2"

BSP HEXAGON PLUG



Size 1/8" - 4"

*Also available from bar

BSP SQUARE PLUG



Size 1/8" - 4"

*Also available from bar

BSP HEX RED BUSH



Size 1/4" x 1/8" - 4" x 3"

BSP HEAVY DUTY FULL SOCKET



Size 1/8" - 6"

*Material certs available

BSP HEAVY DUTY HALF SOCKET



Size 1/8" - 6"

*Material certs available

BSP HOSE TAIL (BAR)



Size 1/8" - 2"

*Material certs available

MANUFACTURED TO BS1740/BS21

BSP 150LB THREADED FITTINGS

Anglo Stainless Ltd · Ossett Lane · Earlsheaton · Dewsbury · West Yorkshire · WF12 8LS

Tel: 01924 430044

Fax: 01924 430229